

# The Hidden Creatures Family Art Trail



Drifting Newt



Running Rabbit



Procter's Barn Meadow



Sleeping Fox

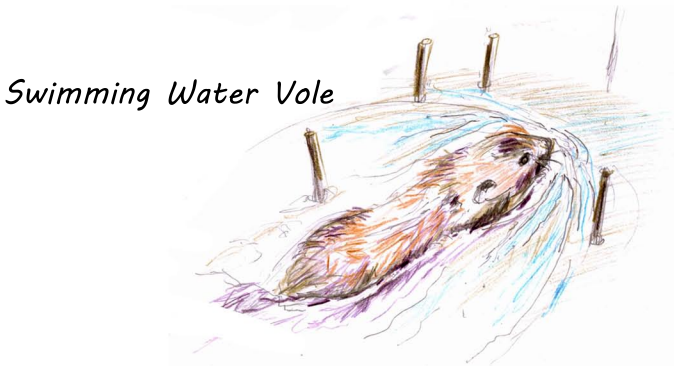

Swimming Water Vole

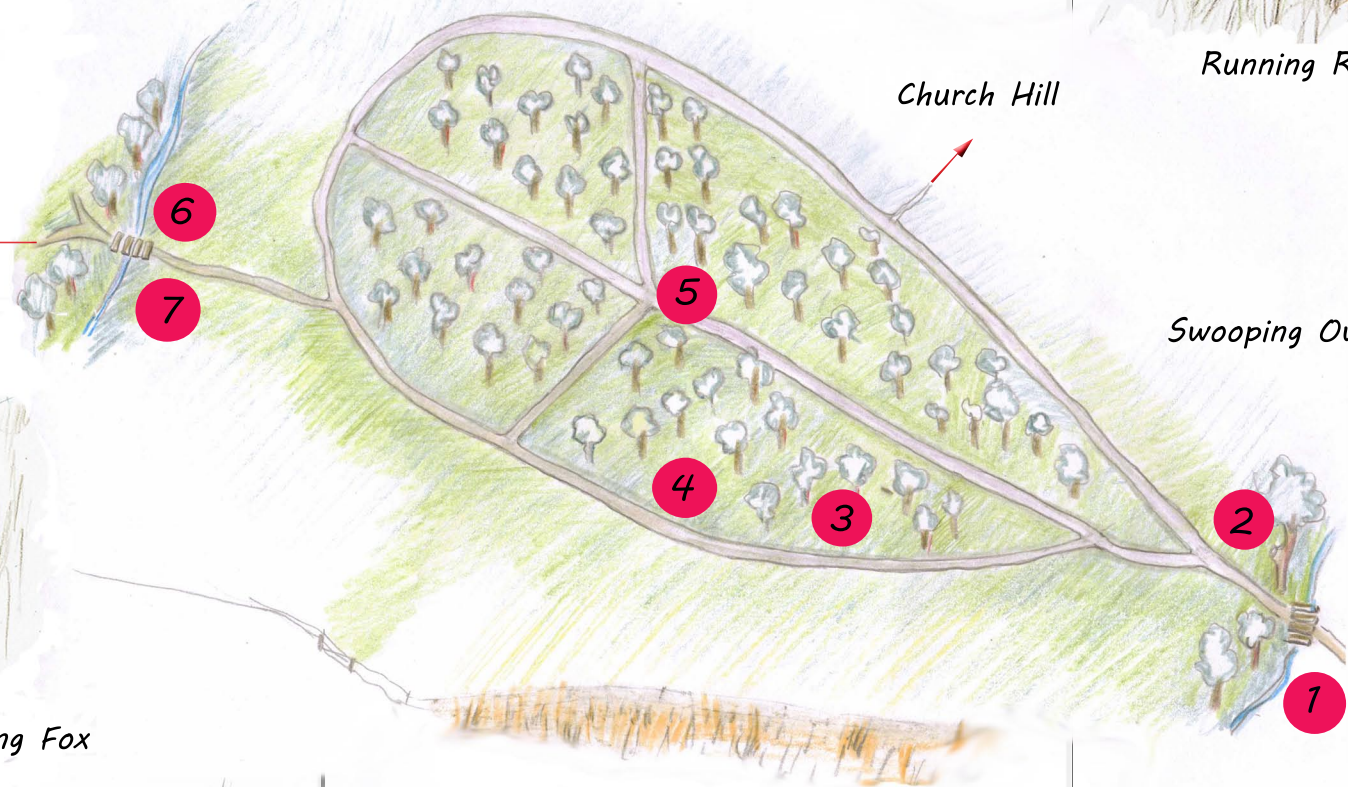

Church Hill

Swooping Owl



The Countryside Centre

Fox and Rabbit Footprints

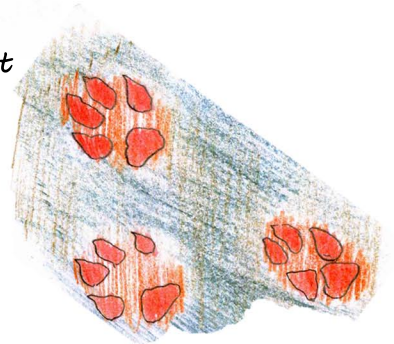

The sculptures are made from recycled red sandstone, mahogany wood and cast iron. They were created by sculptors Keith Ashford and Elizabeth Turner. A different sculpture by Keith and Elizabeth about the Arrow Valley Lake can be found on the other side of the lake path.



# The Hidden Creatures Family Art Trail

When you enter the Arrow Valley Country Park all seems peaceful and quiet. But behind the trees, in the lake and even underground there is a hidden world of creatures leading very busy lives! Explore the Family Art Trail to discover some of the animals and birds that inhabit the park.

1. At the entrance to the Trail look down. Which animals do you think have just run in ahead of you?
2. Look up to see the Barn Owl swooping out from the tree.
3. Find a creature swimming across the surface of the stone.
4. Ssshh! Who is asleep behind this stone?
5. Be quick! The rabbit dives down into his burrow.
6. Can you see the newt drifting in and out of the reeds?
7. At the end of the trail look for the footprints of a water bird that has walked across your path.

We hope you enjoyed your journey around the sculpture trail and discovered lots of creatures along the way!

## Artists

Keith Ashford and  
Elizabeth Turner

[www.sculpturelogic.co.uk](http://www.sculpturelogic.co.uk)



Arrow Valley  
Countryside  
Park